

Wildfire

The hot house

The bushfire lesson plan provides teachers and students with an opportunity to pinpoint wildfire dangers around the home. It asks students to study the simple house plans for the Hot House and to identify the wildfire dangers around the house.

Objectives

The objectives of this lesson plan are to ensure that students are able to:

- ▶ develop an awareness of property protection against wildfires
- ▶ develop their research skills and begin to explore a wider variety of sources
- ▶ express their learning through creative means
- ▶ be assessed on their learning and knowledge of wildfires.

The Hot House

Print out a copy of the *Hot House* to help you prepare your report on all the fire dangers around the home.

You can mark the hotspots around the house using coloured pens or pencils.

Get the facts

To help you prepare your wildfire report, you will need to know some facts about the *Hot House*.

The Hot House is:

- ▶ a single story house
- ▶ made of timber and has a tiled roof
- ▶ surrounded by a wooden paling fence.

Around the yard of the *Hot House*, there is:

- ▶ a garden shed out the back where the lawn mower is stored
- ▶ a woodpile and compost bin next to the living room
- ▶ A car parked out the front of the garage
- ▶ four dead trees on the right-side of the house
- ▶ a big gum tree out the front yard
- ▶ two rows of small native plants with mulch around them on the left-side of the house.

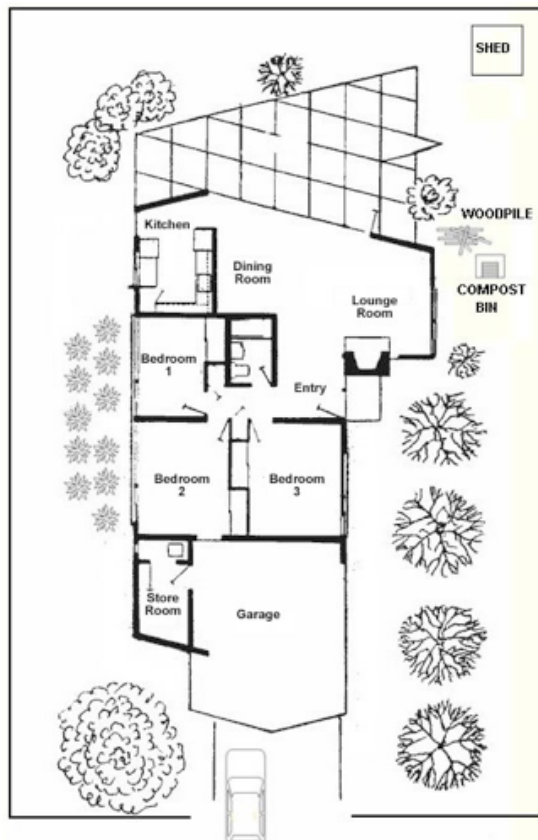

Take time to investigate!

Students can investigate the *Hot House* and all the fire dangers that surround it by working individually, in pairs or groups.

They can find the answers to the following:

1. What are the main fire dangers around the house?
2. What can this family do to protect their home from a bushfire?
3. How do the trees and native plants near the home affect the safety of the house?
4. Can you recommend a better place for the woodpile and compost bin?
5. Is the car a fire threat? Is it better to put it in the garage or leave it where it is?
6. Do you think that the wooden fence is a fire hazard or would it stop flying embers from entering the yard?
7. If you lived here, what would be the first thing you would do if there was a bushfire approaching?

Curriculum links

3	Science	ACSHE050: Science as a Human Endeavour; Nature & Development of Science	Science involves making predictions and describing patterns and relationships
3	Science	ACSHE051: Science as a Human Endeavour; Use and influence of science	Science knowledge helps people to understand the effect of their actions
3	Civics	ACHASSK072: Knowledge and Understanding; Civics and Citizenship	Why people participate within communities and how students can actively participate and contribute
3-4	Health & Physical Education	ACPPS035: Personal, Social and Community Health; Being healthy, safe and active	Describe and apply strategies that can be used in situations that make them feel uncomfortable or unsafe
3-4	Health & Physical Education	ACPPS038: Personal, Social and Community Health	Communicating and interacting for health and wellbeing; investigate how emotional responses vary in depth and strength
4	Science	ACSHE062: Science as a Human Endeavour; Use and influence of science	Science knowledge helps people to understand the effect of their actions
4	Science	CSSU075: Earth and Space Sciences; Nature & development of science	Science involves making predictions and describing patterns and relationships
4	Geography	ACHASSK088: Knowledge and Understanding	The importance of environments, including natural vegetation, to animals and people
5	Geography	ACHASSK113: Knowledge and Understanding	The environmental and human influences on the location and characteristics of a place and the management of spaces within them
5	Geography	ACHASSK114: Knowledge and Understanding	The impact of bushfires or floods on environments and communities, and how people can respond
5-6	Health & Physical Education	ACPPS054: Personal, Social and Community Health	Being healthy, safe and active; Plan and practice strategies to promote health, safety and wellbeing
5-6	Health & Physical Education	ACPPS056: Personal, Social and Community Health	Communicating and interacting with health and wellbeing; Examine the influence of emotional responses on behaviour and relationships
6	Science	ACSSU096: Science Understanding; Earth & Space Science	Sudden geological changes or extreme weather conditions can affect Earth's surface
6	Science	ACSHE098: Science as a Human Endeavour; Nature & Development of Science	Science involves testing predictions by gathering data and using evidence to develop explanations or events and phenomena
6	Science	ACSHE100: Science as a Human Endeavour; Use and influence of science	Scientific understandings, discoveries and inventions are used to solve problems that directly affect peoples' lives