

Planning Scheme Policy – Landscaping

1. Purpose of the planning scheme policy

- (1) The purpose of this planning scheme policy is to:
 - (a) provide design standards for development for acceptable outcomes;
 - (b) provide guidance about satisfying assessment criteria in the planning scheme; and
 - (c) identify information that the local government may require or request for a development application.

2. Interpretation

- (1) Terms used within this planning scheme policy are defined within Schedule 1 of the CairnsPlan 2016 planning scheme. Where a term is not defined in Schedule 1, section 1.3 Interpretation of the CairnsPlan 2016 planning scheme applies.

3. Guidance on meeting planning scheme outcomes

- (1) Landscape promotes and guides the character of the Cairns region as a tropical environment in which the built form is successfully integrated with the natural environment.
- (2) The planning scheme policy promotes the following principles:
 - (a) Offer a selection of tree species suitable to the environmental conditions of the Cairns region;
 - (b) Promote the use of native trees to benefit and enhance our biodiversity and make links to our natural environment;
 - (c) Promote best practice in tree planting to reduce tree failure;
 - (d) Promote the concept of the “urban forest” to provide widespread green cover for our city streets.
- (3) Council may require the preparation of a landscape plan and maintenance schedule and specific landscape and species requirements.
- (4) The information Council may request provides further guidelines for preparing a landscape plan and maintenance schedule.

3.1. Cairns – The Rainforest City

- (1) The purpose of the Cairns – The Rainforest City landscape plan is to provide guidance on landscaping that meets the image and tropical environs of the Cairns City area.
- (2) The document covers the former Cairns City area and divided into the following sections:
 - (a) [Part A](#) – context and document objectives;
 - (b) [Part B](#) – design guidelines;
 - (c) [Part C](#) – tree selection;
 - (d) [Part D](#) – precinct plans – nominates the tree palette and design objectives for each precinct;
 - (e) [Part E](#) – Cairns City Centre – provides a detailed master plan for the Cairns City Centre and addresses both landscape and streetscape issues.

3.2. Related materials

- (1) Other documents which provide guidance on meeting the purpose of the planning scheme outcomes include:
 - (a) Planning Scheme Policy - FNQROC Regional Development Manual.

4. Information Council may request

- (1) A landscape plan and maintenance schedule is to be prepared by a suitably qualified person in accordance with the requirements set out in Table 4.a.

Table 4.a – Details for preparing a landscaping plan

Type	Detail required
Cartographic conventions	Title, date, drawing number; Scale; North Point; Legend; Details of the author (name, qualifications/ experience).
Contextual information	Easements and other encumbrances; Adjoining land uses; Street names; Existing and proposed surface levels.
Existing conditions	Soil types; Existing vegetation – location, size and species; Watercourses; Drainage; Services – underground and overhead.
Extent of works	New vegetation; Existing vegetation protection and/ or removal; Temporary protective drainage and slope stabilisation measures; Soft and hard surface materials; Structures, fencing, retaining walls, entry walls, recreation features, water features, fixtures and furniture; Irrigation system including backflow prevention, filtration details and method of drainage; Hardscape Plan in accordance Figure 4.a – Typical hard landscape plan
Planting plan and schedule	Location, number and minimum size at time of planting; Dimensions of planting beds; Botanic and common names; Endemic or native species to be planted suitable to the area; Quantities and densities; Planting sizes; Canopy height and spread at 2 years and 5 years from planting; Turfing and edging treatments; Planting plan and plant schedule in accordance with Figure 4.b – Typical planting plan and plant schedule.

Type	Detail required
Landscape specification	<p>A description of the overall scope of the landscape works;</p> <p>A schedule of drawings to be read in conjunction with the specification;</p> <p>Details of standards and guidelines to be followed;</p> <p>Description of site preparation measures including protection measures of existing vegetation, protective drainage and slope stabilisation measures, protection of existing site features, weed eradication, soil preparation and stockpiling and mulching.</p>
Maintenance schedule	<p>Details of maintenance monitoring, inspection and reporting;</p> <p>Specified time periods and work requirements for routine maintenance over a period of a year once the landscaping has been established;</p> <p>Outline requirements and details of pruning, trimming, weeding, re-mulching and restructuring of plants;</p> <p>Annual budget costs.</p>

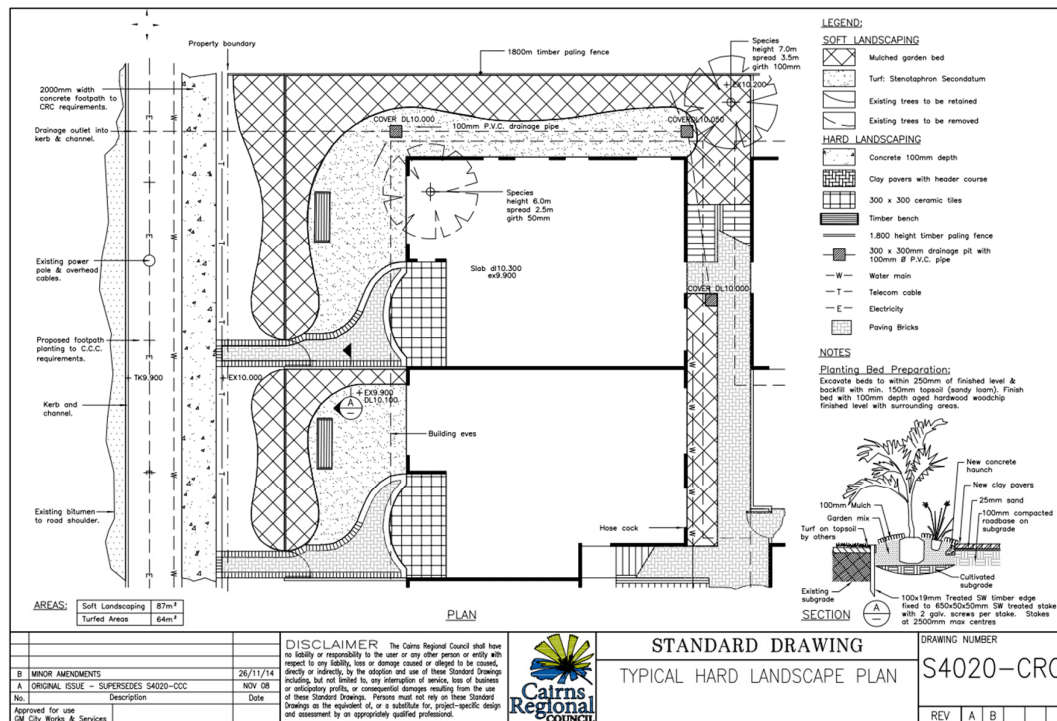

Figure 4.a – Typical hard landscape plan

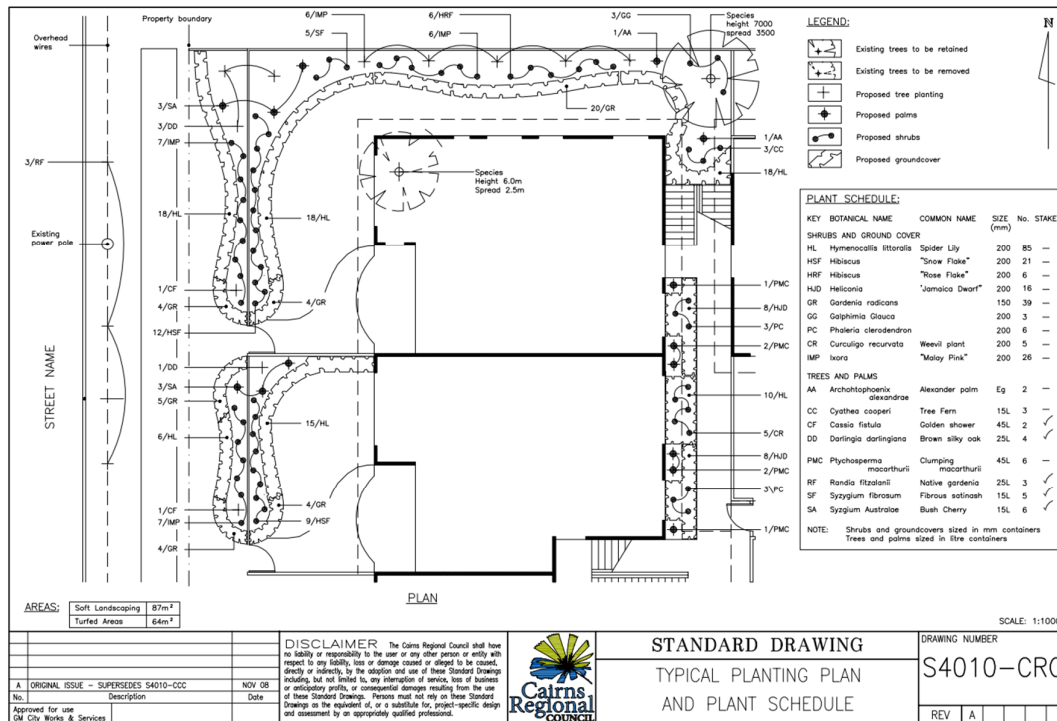

Figure 4.b – Typical planting plan and plant schedule

5. Schedule of amendments

Table 5.a – Schedule of amendments

Amendment title	Version number	Description	Dates
CairnsPlan 2016 Amendment 1 of 2017 - Administrative	1.1	The amendment integrates the Cairns Local Government Infrastructure Plan and corrects formatting, numbering, outdated terms and factual matters incorrectly stated in the planning scheme.	Adopted 28 June 2017 Commenced 1 July 2017
Planning Scheme Policy – Landscaping Amendment 1 of 2017 - Administrative	1.2	The amendment corrects formatting and numbering to remove the Planning Scheme Policy from Schedule 6 of the CairnsPlan 2016 and includes a schedule of amendments.	Adopted 6 December 2017 Commenced 11 December 2017
Planning Scheme Policy – Landscaping Amendment 1 of 2021 – Administrative	1.3	The amendment updates and corrects references in the planning scheme policy. This amendment introduces a cross-reference to the planning scheme definitions in Schedule 1 of CairnsPlan 2016.	Adopted 13 October 2021 Commenced 26 October 2021